

Tammiston Tähti



Ylästöntie 12, Tammisto
01510, Vantaa

 OP Business Premises

Tammiston Tähti

Property information

Tammiston Tähti is an attractive commercial property with a prominent location in the middle of the commercial area of Tammisto.

Completed in 2010, this commercial property with approximately 4300 m² of retail space is a modern concentration of specialized stores. The commercial premises are spacious, showroom-type retail spaces. The property utilizes solar energy with its own solar cells.

In-house services

- ✓ Canteen

Nearby services

- ✓ Restaurant
- ✓ Health club
- ✓ Grocery
- ✓ Car wash
- ✓ Hotelli



Tammiston Tähti

Vuokrattavat toimitilat

Retail 221 sqm / ground floor

Street address: Nilsaksenpolku 2, 01510 Vantaa

Availability: Soon available

Leasing contact:



Viktoria Mönkkönen
Newsec Property Asset Management
040 651 6342
viktoria.monkkonen@newsec.fi

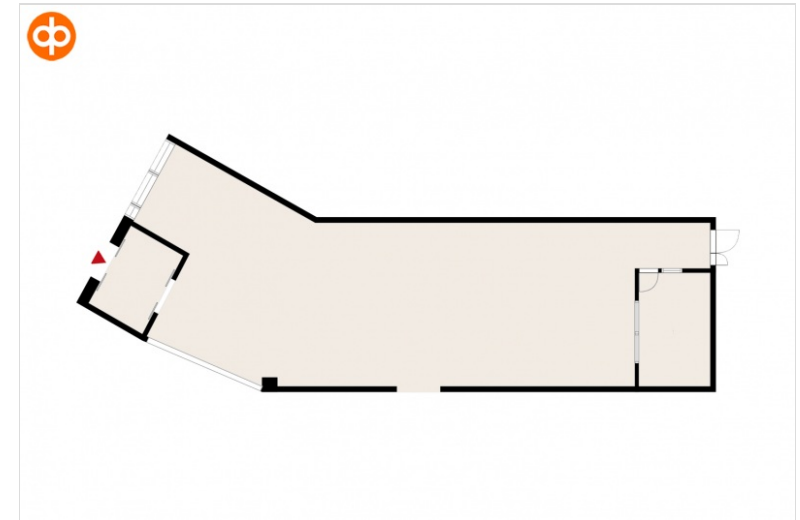
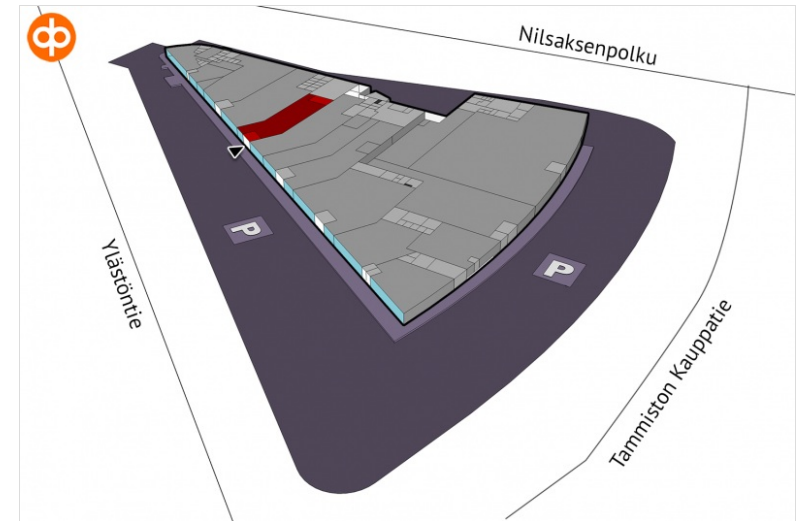

Tammiston Tähti

Location

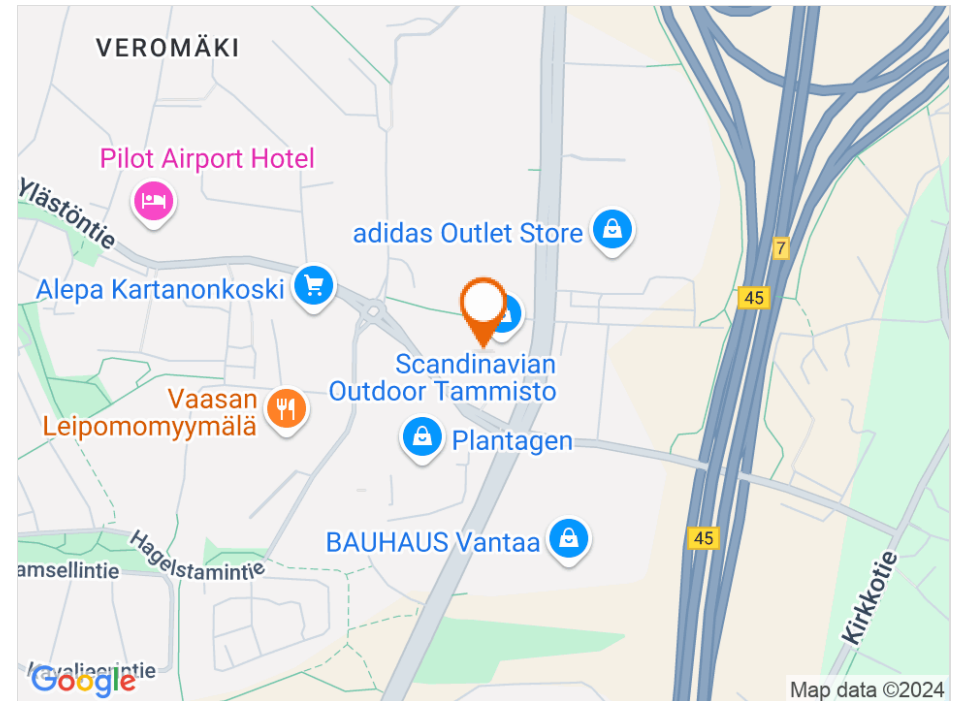
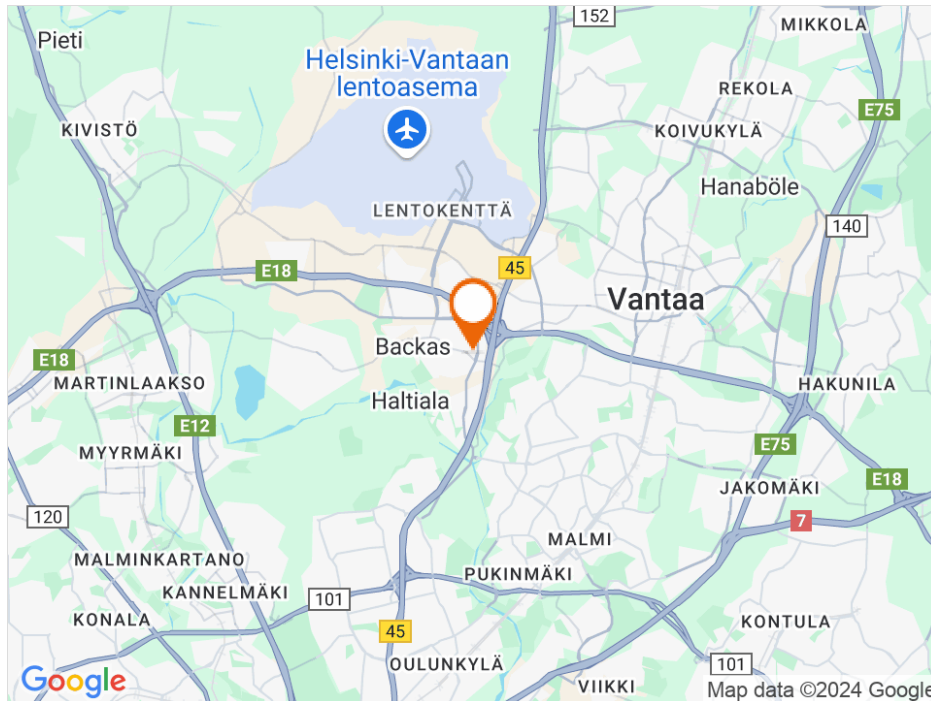

Ylästöntie 12, Tammisto, 01510 Vantaa

Transport links

 Bussipysäkki 100 m  Juna-asema 3,4 km  Lentoasema 4,5 km

OP Kiinteistösijoitus Oy vuokraa toimitiloja

OP Real Estate Asset Management Ltd is a real estate asset management company owned by OP Financial Group. As a landlord, we represent several quarters within our group. In addition, we manage real estate investments in real estate funds and direct real estate investments by our customers. We are one of the largest real estate asset managers in Finland.

Our leasing partner is Newsec Property Asset Management Finland Oy. Our primary contact persons are:

In matters of leasing agreements and properties, our customers are served by our property managers:



Viktoria Mönkkönen
tel. +358 40 651 6342
viktoria.monkkonen@newsec.fi



Jari Vepsäläinen
p. 010 252 2322
jari.vepsalainen@op.fi



Jaan Laakkonen
tel. +358 50 597 8101
jaan.laakkonen@newsec.fi



Jarl Virala
p. 010 252 7278
jarl.virala@op.fi



OP Business Premises

Visiting adress: Gebhardinaukio 1, 00510
Helsinki | Mailing adress: PL 1068, FI-00013 OP
| Tel.: +358 10 252 010 (switch)